

Metric Grippers "EMCT"-Carbide Tipped



E & E Metric Grippers are available for worldwide distribution. They come in hardened tool steel, carbide tipped and adjustable varieties. Metric grippers will be particularly useful in the metric jig and fixture modules which are gaining popularity in the U.S.A.

ROUND DESIGN								
CAD FILE NAME	PART NUMBER	A	B	C	D	E	F	TOOTH PATT.
EMCT100	EMCT-100	10	10	4.5	4.75	5/16	M5 x 0.8	EX-FINE
EMCT120	EMCT-120	12	10	4.5	4.75	3/8	M5 x 0.8	FINE
EMCT122	EMCT-122	12	12	6	4.75	3/8	M5 x 0.8	FINE
EMCT160	EMCT-160	16	10	4.5	4.75	1/2	M6 x 1.0	FINE
EMCT200	EMCT-200	20	10	4.5	4.75	5/8	M6 x 1.0	FINE
EMCT250	EMCT-250	25	10	4.5	4.75	3/4	M6 x 1.0	FINE
EMCT840	EMCT-840EF	12.7	12.7	5.9	4.75	9.5	M6 x 1.0	EX-FINE
EMCT841	EMCT-841EF	12.7	9.5	4.4	4.75	9.5	M6 x 1.0	EX-FINE
EMCT842	EMCT-842EF	12.7	16.5	7.5	4.75	9.5	M6 x 1.0	EX-FINE
EMCT850	EMCT-850	15.9	9.5	4.4	4.75	12.7	M6 x 1.0	EX-FINE
EMCT860	EMCT-860	19.1	9.5	4.4	4.75	15.9	M6 x 1.0	EX-FINE

SQUARE DESIGN								
CAD FILE NAME	PART NUMBER	A	B	C	D	E	F	TOOTH PATT.
EMCT9120	EMCT-9120	12	10	—	—	13/32	M5 x 0.8	FINE
EMCT870	EMCT-870EF	12.7	12.7	—	—	10.3	M6 x 1.0	EX-FINE

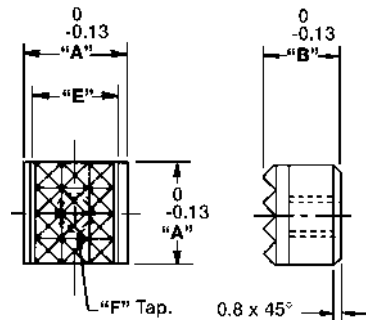
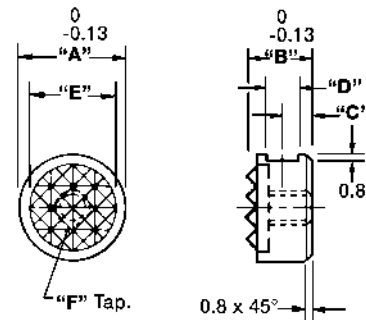

Metric

Metric Grippers "EMCTH"-Threaded

"EMCTH" ADJUSTABLE							
CAD FILE NAME	PART NUMBER	A	B	C HEX	D	E THD.	TOOTH PATT.
EMC610	EMCTH-06100	25	5	10	5/16	M6 x 1.00	EX-FINE
EMC8125	EMCTH-08125	25	6.4	13	3/8	M8 x 1.25	FINE
EMC81253	EMCTH-08125 x 35	35	6.4	13	3/8	M8 x 1.25	FINE
EMC1015	EMCTH-10150	25	8.3	17	1/2	M10 x 1.50	FINE
EMC10154	EMCTH-10150 x 40	40	8.3	17	1/2	M10 x 1.50	FINE
EMC1217	EMCTH-12175	25	8.7	19	5/8	M12 x 1.75	FINE
EMC12174	EMCTH-12175 x 40	40	8.7	19	5/8	M12 x 1.75	FINE
EMC162	EMCTH-16200	35	11	24	3/4	M16 x 2.00	FINE
EMC1625	EMCTH-16200 x 50	50	11	24	3/4	M16 x 2.00	FINE
EMC2025	EMCTH-20250	40	13.7	30	1	M20 x 2.50	EX-FINE
EMC20256	EMCTH-20250 x 60	60	13.7	30	1	M20 x 2.50	EX-FINE

