

Style "D" & "E" Scribe Check Pin

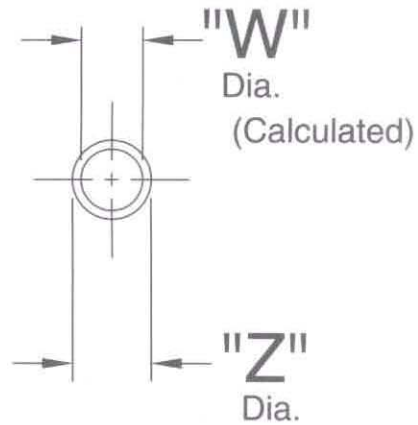
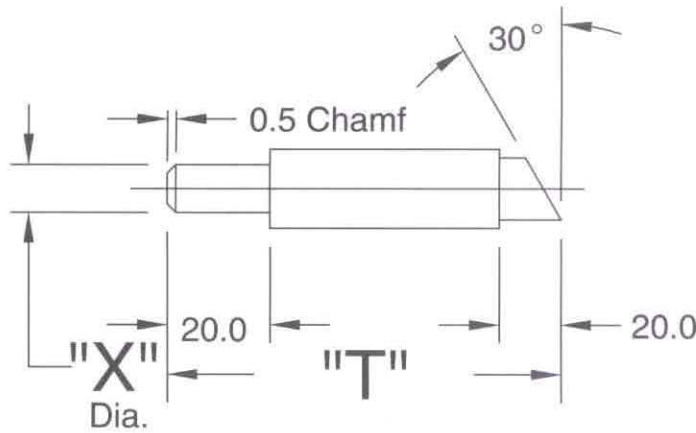

SCRIBE MEMBER

GAGE IDENTIFICATION: "D"
(WITH PILOT SHAFT)

NOM. DIA.	"T"
04.00-17.50	80MM
18.00-27.50	110MM
28.00-40.50	125MM
41.00-50.50	140MM

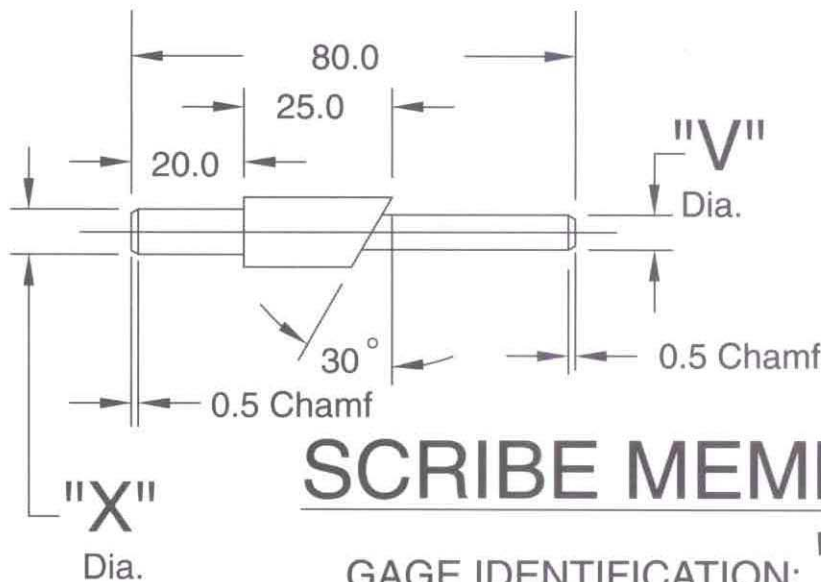

SCRIBE MEMBER

GAGE IDENTIFICATION: "E"
(WITH PILOT LEAD)

Style "D" & "E" Scribe Check Pin

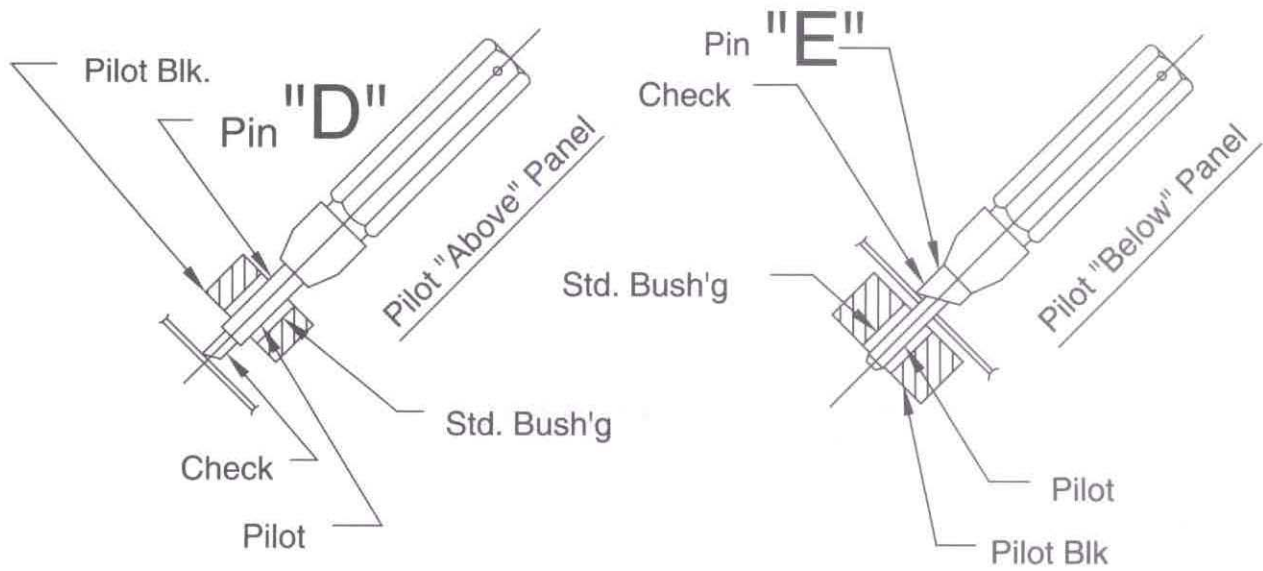

SCRIBE PIN ASM.

PIN ORDERING EXAMPLES

EXAMPLES HOLE SIZE: 9.00mm HOLE +0.03/-0.15

EXAMPLES LOCATION TOL: $\oplus 1.5$ \odot A B C

ORDER EXAMPLE FOR SINGLE ENDED PIN ASSEMBLIES, STYLES "D" "E"

PIN# "D" STANDARD PIN			
LOC.	<input type="checkbox"/>	MMC	<input type="checkbox"/>
		SCRIBE	<input checked="" type="checkbox"/>
GO/NO-GO	<input type="checkbox"/>	NO-GO	GO
HOLE SIZE			9.55
LOCATION TOL.			4.00 *
HOLE SIZE TOL.			
NOM. CALCULATED PIN SIZE			13.55
ORDER#	N	09.55 D	14.00
BUSHING CALL OUT		P64-16-	16.00

PIN# "E" STANDARD PIN			
LOC.	<input type="checkbox"/>	MMC	<input type="checkbox"/>
		SCRIBE	<input checked="" type="checkbox"/>
GO/NO-GO	<input type="checkbox"/>	NO-GO	GO
HOLE SIZE			9.55
LOCATION TOL.			4.00
HOLE SIZE TOL.			
NOM. CALCULATED PIN SIZE			13.55
ORDER#	N	09.55 E	14.00
BUSHING CALL OUT		P20-12-	4.00

* SEE NOTE 1 (See Page 11)

NEW DESIGNATION
Nominal Hole Dia.
Gage Member I.D.
Diameter "W"

NEW DESIGNATION
Nominal Hole Dia.
Gage Member I.D.
Diameter "W"

SEE PAGES 18 & 19 FOR STANDARD SIZE LISTING